

NOTA: SISTEM DE PROIECTIE STEREOGRAFIC 1970  
SISTEM DE REFERINTA MAREA NEAGRA 1975



DETALIUL "A"

Cabluri existente 200x2x0,7 + 100x2x0,7 + 50x2x0,7  
instalate in sapatura

Cablu cu fibra optica 20" existent  
ADSS - fara elemente metalice  
instalat pe stalpi Lc existenti

Cabluri instalate in sapatura  
200x2x0,7 + 100x2x0,7 + 50x2x0,7 armate & ecranate  
faza definitiva

Cabluri instalate in protectie metalica (Suthzeisen)  
pe trotuarul pietonal  
200x2x0,7 + 100x2x0,7 + 50x2x0,7 armate & ecranate  
faza definitiva

Cabluri existente instalate in protectie metalica  
pe trotuarul pietonal  
200x2x0,7 + 100x2x0,7 + 50x2x0,7

Cabluri instalate in sapatura  
200x2x0,7 + 100x2x0,7 + 50x2x0,7 armate & ecranate  
faza definitiva

Cabluri existente 200x2x0,7 + 100x2x0,7 + 50x2x0,7  
instalate in sapatura

3 Mufe de jonctiune definitive  
200x2x0,7 + 100x2x0,7 + 50x2x0,7

Mufa de jonctiune provizorie  
50x2x0,4 cu 50x2x0,7

Cablu 50x2x0,4 armat & ecranat  
instalat provizoriu in sapatura

Cablu 50x2x0,4 armat & ecranat  
instalat provizoriu in protectie metalica (Suthzeisen)

Cablu 50x2x0,4 armat & ecranat  
instalat provizoriu in sapatura

3 Mufe de jonctiune definitive  
200x2x0,7 + 100x2x0,7 + 50x2x0,7



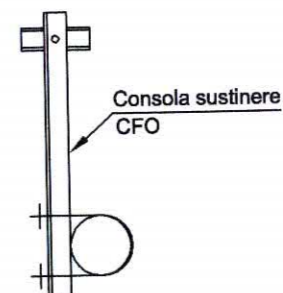

Mufa de jonctiune provizorie  
50x2x0,4 cu 50x2x0,7

DETALIUL "A"



NOTA:  
Planificarea lucrarilor la podul de la  
km 57+540 se va face ulterior finalizarii  
lucrarilor la podul de la km 57+560 fir II.



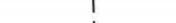

### LEGENDA

-  Mufa jonctiune (rosu faza definitiva, albastru faza provizorie)
-  Cabluri existente
-  Cabluri in sapatura (rosu faza definitiva, albastru faza provizorie)
-  Cablu existent in protectie metalica (Suthzeisen)
-  Cablu faza provizorie in protectie metalica (Suthzeisen)
-  Cablu faza definitiva in protectie metalica (Suthzeisen)

ATENTIE !

CABLURI  
EXISTENTE IN FUNCTIUNE

RESPECTATI MASURILE PRIVIND  
SANATATEA SI SECURITATEA IN MUNCA  
SI SITUATIILE DE URGENTA

B				
A				
BENEFICIAR / BENEFICIARY:  ROMANIAN RAILWAY NATIONAL COMPANY		Modificare Modification / Revision AUTORITATEA DE IMPLEMENTARE / IMPLEMENTUNG AUTHORITY Ministerul Transporturilor Ministry of Transports		AUTORITATEA CONTRACTANTA / CONTRACTING AUTHORITY  CFCU Ministerul Economiei si Finantelor Oficiu de Plati si Contractare Phare Ministry of Economy and Finances Phare Payments & Contracting Office
 printec		 CONSIG PROJECT		Contract / Contract: 1303/2007
Intocmit Designed		Ing. Raliade Lucian	Scara / Scale: 1:500	Faza / Phase: Pth+DE
Verificat Checked		Ing. Enache Florin	Data / Date:	
Sef echipa Team leader		Ing. Stelian Vara-Oros	07.2010	Denumire desen / Drawing Title: Sucursala RCF / Railway district BUCURESTI Linia cf / Railway line 300 Bucuresti - Ploiesti Pod / Bridge km 57+560 Protectie cabluri de telecomunicatii la pod/Bridge TTR cables protection
				Cod desen / Drawing Code: PD 21
				Nr. / No: 01 16

579750



379000

579800

← BUCURESTI

← PLOESTI TRIAJ

DETALIUL "A"

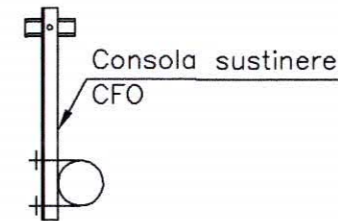

DETALIUL "A"

Cablu FO existent 20" instalat pe stalpi LC

Cablu FO existent 20" mutat provizoriu pe stalpi LC

- NOTA:**  
 CFO se va proteja in doua etape cu desfacerea rezervelor adiacente podului si ancorare provizorie:  
 1 - relocare provizorie pe stalpi LC fir I;  
 2 - instalare definitiva pe stalpii LC noi fir II.

LEGENDA

- Cablu fibra optica 20" existent
- Cablu fibra optica 20" existent, mutat provizoriu
- Varfar la stalp existent
- Ancora cablu FO la stalp existent

**ATENTIE!**  
 CABLURI  
 EXISTENTE IN FUNCTIUNE

---

RESPECTATI MASURILE PRIVIND  
 SANATATEA SI SECURITATEA IN MUNCA  
 SI SITUATIILE DE URGENTA

B			
A			
		Modificare Modification / Revision	
BENEFICIAR / BENEFICIARY:		AUTORITATEA DE IMPLEMENTARE / IMPLEMENTING AUTHORITY	AUTORITATEA CONTRACTANTA / CONTRACTING AUTHORITY
ROMANIAN RAILWAY NATIONAL COMPANY Ministerul Transporturilor Ministry of Transports		MINISTERUL ECONOMIEI SI FINANTELOR Ministry of Economy and Finance Oficiul de Plati si Contractare Phare Payments & Contracting Office	Contract / Contract: 1303/2007  Faza / Phase: Pth+DE
prointec		CONSIS PROIECT	POS Transport 2007- 2013  
Intocmit / Designed:	Ing. Raliade Lucian	Scara / Scale:	1:500
Verificat / Checked:	Ing. Enache Florin	Data / Date:	07.2010
Sef echipa / Team leader:	Ing. Stelian Vara-Oros	PORTOFOLIUL DE PROIECTE PHARE CES 2005 / PHARE CES 2005 PROJECTS PORTFOLIO LOT 1 Asistenta tehnica pentru pregatirea unor lucrari de reabilitare pentru tuneluri si poduri de cale ferata Technical assistance for preparing rehabilitation works required by railway tunnels and bridges	
Denumire desen / Drawing Title:		Cod desen / Drawing Code:	Nr. / No.:
Sucursala RCF / Railway district Bucuresti Linia cf / Railway line 300 Bucuresti-Ploesti Pod / Bridge km 57+560		PD 21	02 / 16
Protectie cabluri de telecomunicatii la pod/Bridge TTR cables protection			

Plan 02/16

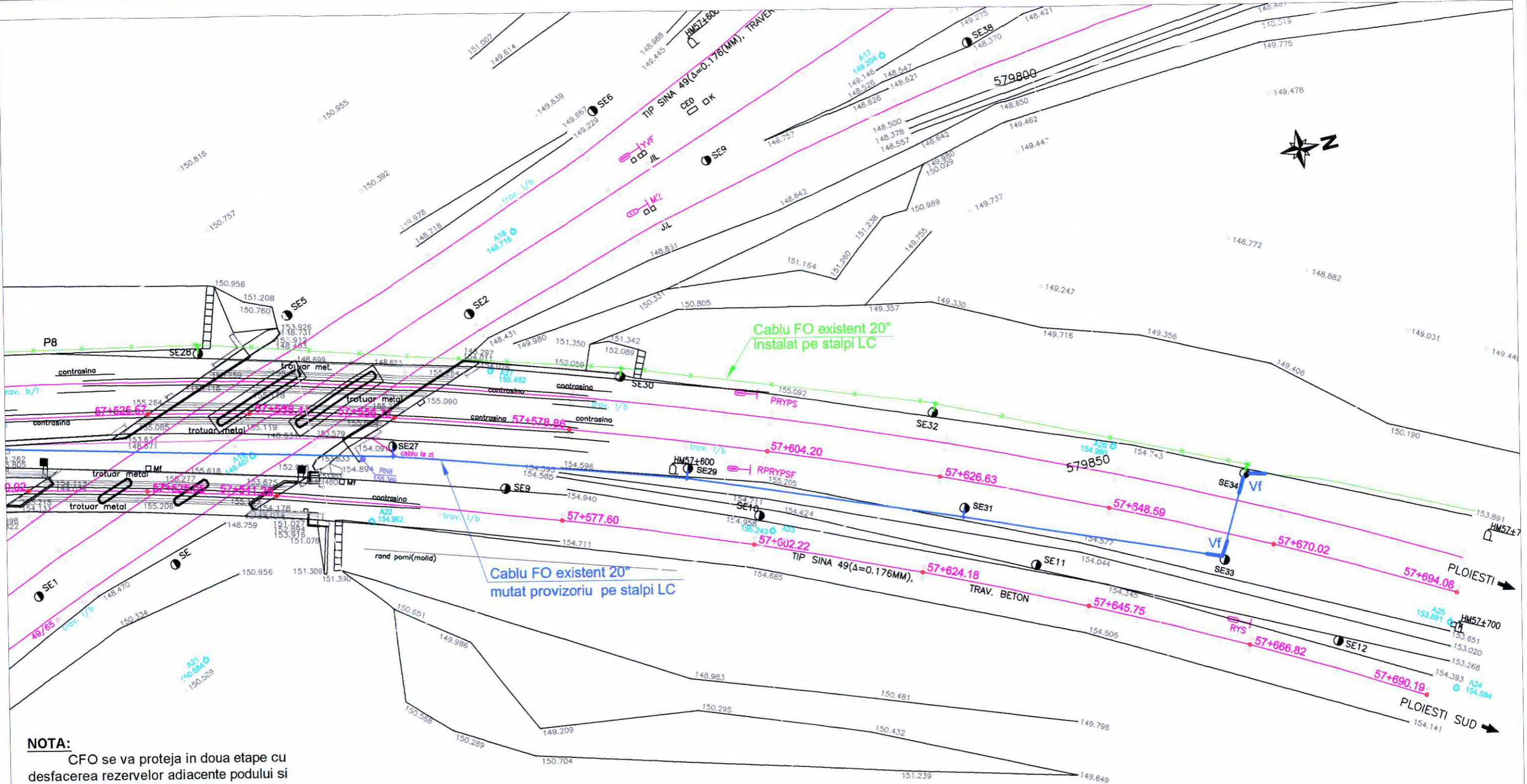

**NOTA:**  
 CFO se va proteja in doua etape cu desfacerea rezervelor adiacente podului si ancorare provizorie:  
 1 - relocare provizorie pe stalpi LC fir I;  
 2 - instalare definitiva pe stalpii LC noi fir II.

**ATENTIE !**  
**CABLURI**  
**EXISTENTE IN FUNCTIUNE**

---

**RESPECTATI MASURILE PRIVIND**  
**SANATATEA SI SECURITATEA IN MUNCA**  
**SI SITUATIILE DE URGENTA**



B				
A				
		Modificare Modification / Revision		
BENEFICIAR/ BENEFICIARY:		AUTORITATEA DE IMPLEMENTARE/ IMPLEMENTUNG AUTHORITY		 <b>CFCU</b> Contract / Contract: 1303/2007
 ROMANIAN RAILWAY NATIONAL COMPANY		Ministerul Transporturilor Ministry of Transports		
		 Proiect finantat de UNIUNEA EUROPEANA Project financed by EUROPEAN UNION		POS Transport 2007- 2013 
		 <b>prointec</b>		
		 <b>CONSI PROIECT</b>		PORTOFOLIUL DE PROIECTE PHARE CES 2005 / PHARE CES 2005 PROJECTS PORTFOLIO LOT 1 Asistenta tehnica pentru pregatirea unor lucrari de reabilitare pentru tuneluri si poduri de cale ferata Technical assistance for preparing rehabilitation works required by railway tunnels and bridges
Intocmit Designed		Ing. Raliade Lucian	Scara / Scale : 1:500	
Verificat Checked		Ing. Enache Florin	Data / Date :	
Sef echipa Team leader		Ing. Stelian Vara-Oros	07.2010	
		Denumire desen / Drawing Title : Sucursala RCF/ Railway district Bucuresti Linia cf /Railway line 300 Bucuresti-Ploiesti Pod / Bridge km 57+560		Cod desen / Drawing Code: PD 21
		Protectie cabluri de telecomunicatii la pod/Bridge TTR cables protection		Nr. / No. 03 16

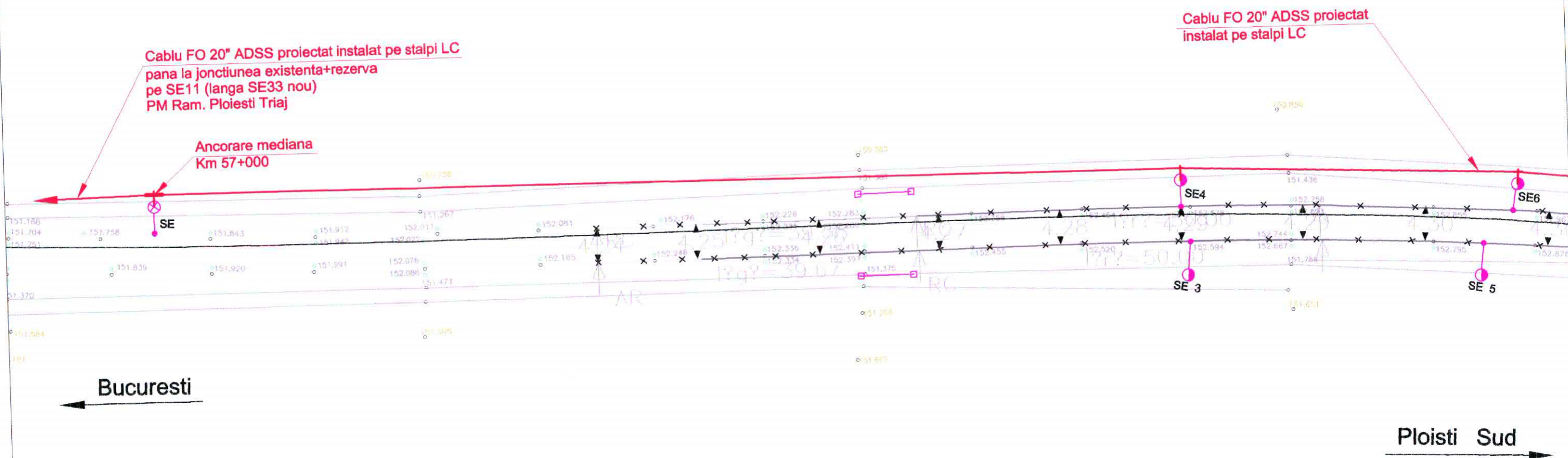

Plan 05/16

**NOTA:**  
 CFO se va proteja in doua etape cu desfacerea rezervelor adiacente podului si ancorare provizorie:  
 1 - relocare provizorie pe stalpi LC fir I;  
 2 - instalare definitiva pe stalpii LC noi fir II.

**ATENTIE!**  
**CABLURI**  
**EXISTENTE IN FUNCTIUNE**

---

**RESPECTATI MASURILE PRIVIND**  
**SANATATEA SI SECURITATEA IN MUNCA**  
**SI SITUATIILE DE URGENTA**

**LEGENDA**

— Cablu fibra optica 20" proiectat, relocat definitiv

⊕ Ancora cablu FO la stalp nou

B			
A			
BENEFICIAR / BENEFICIARY:		AUTORITATEA DE IMPLEMENTARE / IMPLEMENTING AUTHORITY	
 ROMANIAN RAILWAY NATIONAL COMPANY Ministerul Transporturilor Ministry of Transport		 AUTORITATEA CONTRACTANTA / CONTRACTING AUTHORITY Ministerul Economiei si Finantelor Oficiul de Plati si Contractare Phare Ministry of Economy and Finances Phare Payments & Contracting Office CFCU	
 		 POS Transport 2007-2013	
Intocmit / Designed		Ing. Raliade Lucian	Scara / Scale: 1:500
Verificat / Checked		Ing. Enache Florin	Data / Date: 07.2010
Sef echipa / Team leader		Ing. Stelian Vara-Oros	
PORTOFOLIUL DE PROIECTE PHARE CES 2005 / PHARE CES 2005 PROJECTS PORTFOLIO LOT 1 Asistenta tehnica pentru pregatirea unor lucrari de reabilitare pentru tuneluri si poduri de cale ferata Technical assistance for preparing rehabilitation works required by railway tunnels and bridges Denumire desen / Drawing Title: Sucursala RCF / Railway district Bucuresti Linia cf / Railway line 300 Bucuresti-Ploiesti Pod / Bridge km 57+580 Protectie cabluri de telecomunicatii la pod/Bridge TTR cables protection			
			Cod desen / Drawing Code: PD 21 Nr. Cont: 1303/ Fa Ph Pth

Plan 04/16



Cablu FO 20" ADSS proiectat instalat pe stalpi LC

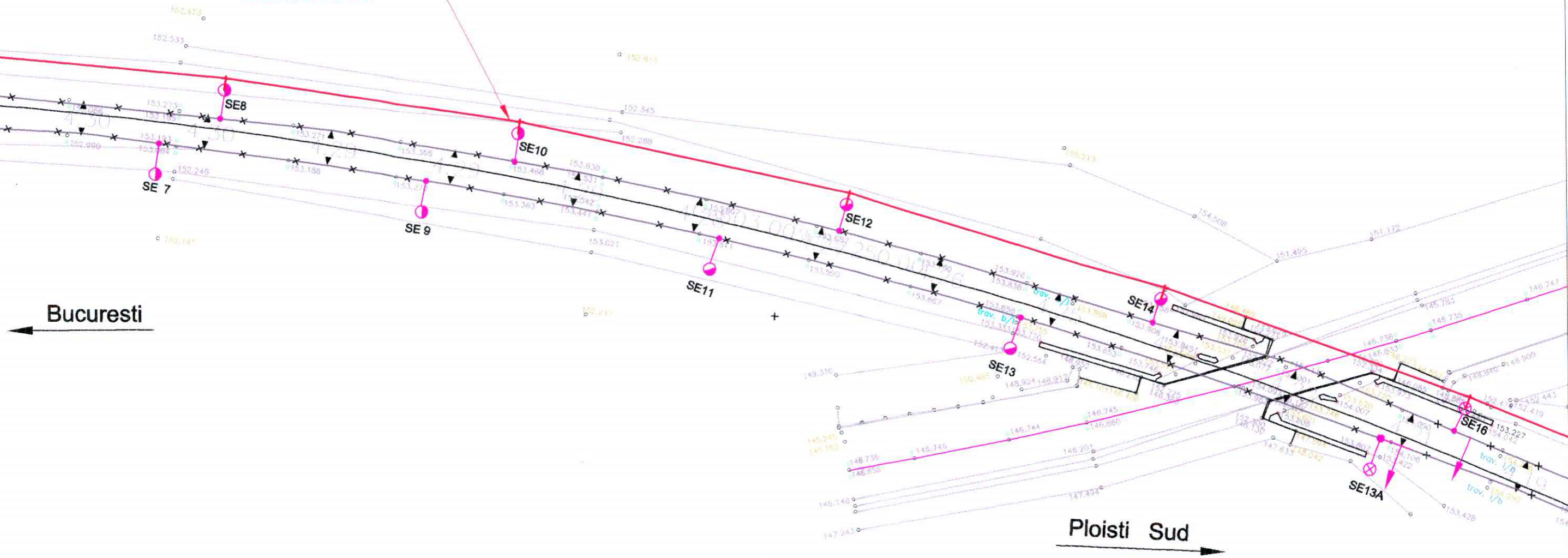

Plan 06/16

**NOTA:**

- CFO se va proteja in doua etape cu desfacerea rezervelor adiacente podului si ancorare provizorie:
- 1 - relocare provizorie pe stalpi LC fir I;
  - 2 - instalare definitiva pe stalpii LC noi fir II.

**ATENTIE!**  
CABLURI  
EXISTENTE IN FUNCTIUNE

---

RESPECTATI MASURILE PRIVIND  
SANATATEA SI SECURITATEA IN MUNCA  
SI SITUATIILE DE URGENTA

**LEGENDA**

— Cablu fibra optica 20" proiectat, relocat definitiv

—⊕— Ancora cablu FO la stalp nou

B						
A						
Modificare Modification / Revision						
BENEFICIAR / BENEFICIARY:		AUTORITATEA DE IMPLEMENTARE / IMPLEMENTUNG AUTHORITY		AUTORITATEA CONTRACTANTA / CONTRACTING AUTHORITY		
 ROMANIAN RAILWAY NATIONAL COMPANY		Ministerul Transporturilor Ministry of Transports		 Ministerul Economiei si Finantelor Oficiul de Plati si Contractare Phare Ministry of Economy and Finances Phare Payments & Contracting Office		
		Proiect finantat de UNIUNEA EUROPEANA Project financed by EUROPEAN UNION		POS Transport 2007- 2013		
Intocmit / Designed		Ing. Raliade Lucian		Scara / Scale :		
Verificat / Checked		Ing. Enache Florin		1:500		
Sef echipa / Team leader		Ing. Stelian Vara-Oros		Data / Date :		
				07.2010		
<b>PORTOFOLIUL DE PROIECTE PHARE CES 2005 / PHARE CES 2005 PROJECTS PORTFOLIO LOT 1</b>						
Asistenta tehnica pentru pregatirea unor lucrari de reabilitare pentru tuneluri si poduri de cale ferata Technical assistance for preparing rehabilitation works required by railway tunnels and bridges						
Denumire desen / Drawing Title:				Cod desen / Drawing Code		Nr. / Nc
Sucursala RCF/ Railway district Bucuresti Linea cf/ Railway line 300 Bucuresti-Ploiesti Pod / Bridge km 57+560				PD 21		05 / 16
Protectie cabluri de telecomunicatii la pod/Bridge TTR cables protection						

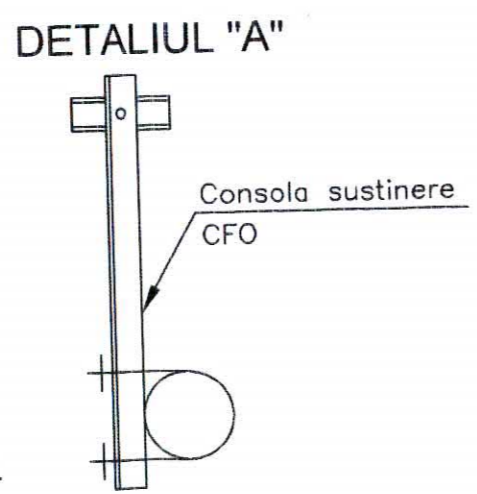
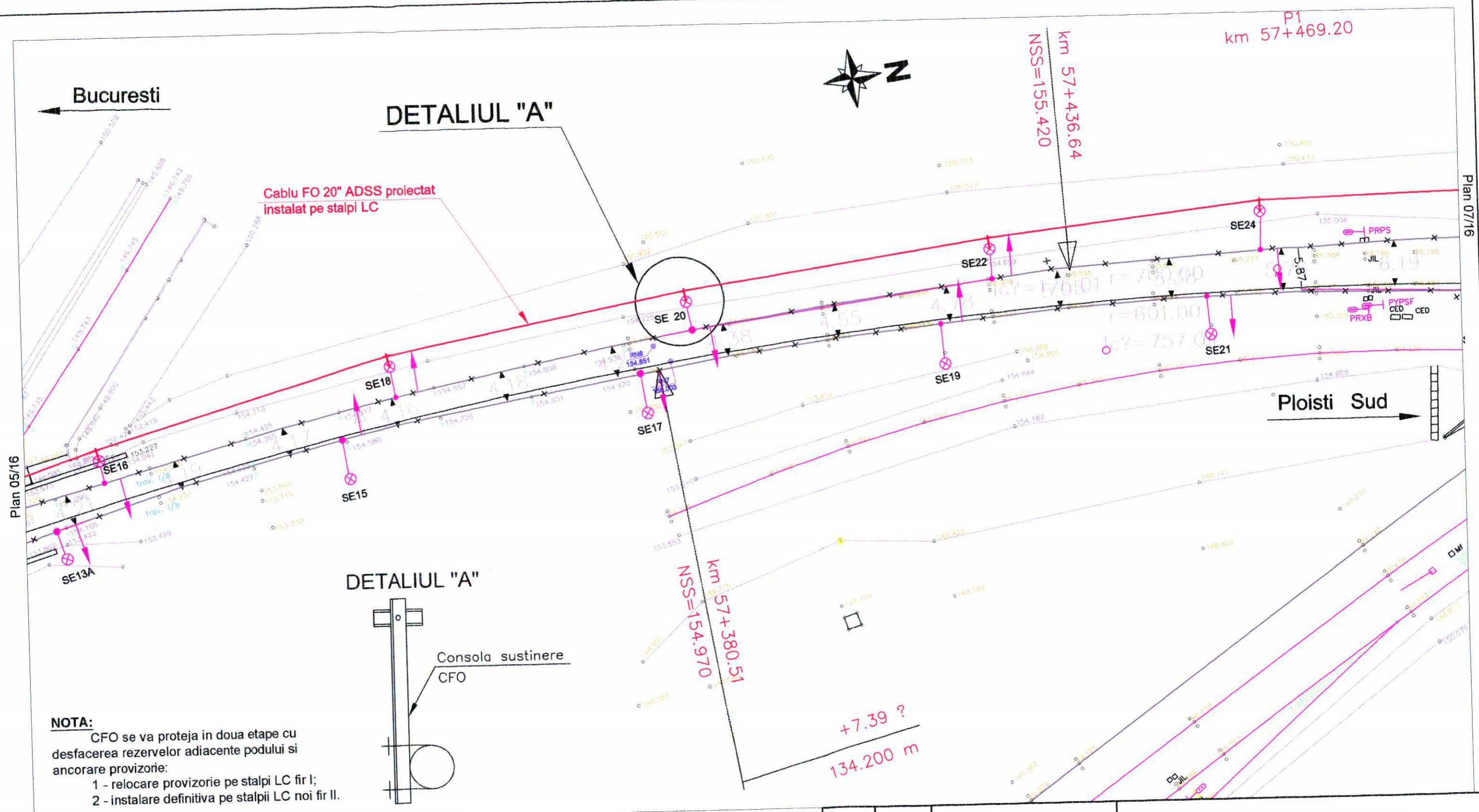

**NOTA:**  
CFO se va proteja in doua etape cu desfacerea rezervelor adiacente podului si ancorare provizorie:  
1 - relocare provizorie pe stalpi LC fir I;  
2 - instalare definitiva pe stalpii LC noi fir II.

**ATENTIE!**  
CABLURI  
EXISTENTE IN FUNCTIUNE

RESPECTATI MASURILE PRIVIND  
SANATATEA SI SECURITATEA IN MUNCA  
SI SITUATIILE DE URGENTA

**LEGENDA**

	Cablu fibra optica 20" proiectat, relocat definitiv
	Ancora cablu FO la stalp nou

B				
A				
BENEFICIAR/ BENEFICIARY:		Modificare Modification / Revision	AUTORITATEA CONTRACTANTA / CONTRACTING AUTHORITY	
ROMANIAN RAILWAY NATIONAL COMPANY		AUTORITATEA DE IMPLEMENTARE/ IMPLEMENTUNG AUTHORITY	Ministerul Economiei si Finantelor Oficiul de Plati si Contractare Phare Ministry of Economy and Finances Phare Payments & Contracting Office	
		Proiect finantat de UNIUNEA EUROPEANA Project financed by EUROPEAN UNION		POS Transport 2007- 2013
Intocmit Designed		Ing. Raliade Lucian	Scara / Scale:	<b>PORTOFOLIUL DE PROIECTE PHARE CES 2005 / PHARE CES 2005 PROJECTS PORTFOLIO LOT 1</b> Asistenta tehnica pentru pregatirea unor lucrari de reabilitare pentru tuneluri si poduri de cale ferata Technical assistance for preparing rehabilitation works required by railway tunnels and bridge
Verificat Checked		Ing. Enache Florin	1:500	
Sef echipa Team leader		Ing. Stelian Vara-Oros	Data / Date:	
			07.2010	Denumire desen / Drawing Title: Sucursala RCF/ Railway district Bucuresti Linia cf /Railway line 300 Bucuresti-Ploiesti Pod / Bridge km 57+560 Protectie cabluri de telecomunicatii la pod/Bridge TTR cables protection
				Cod desen / Drawing Code PD 21
				Nr. / 01

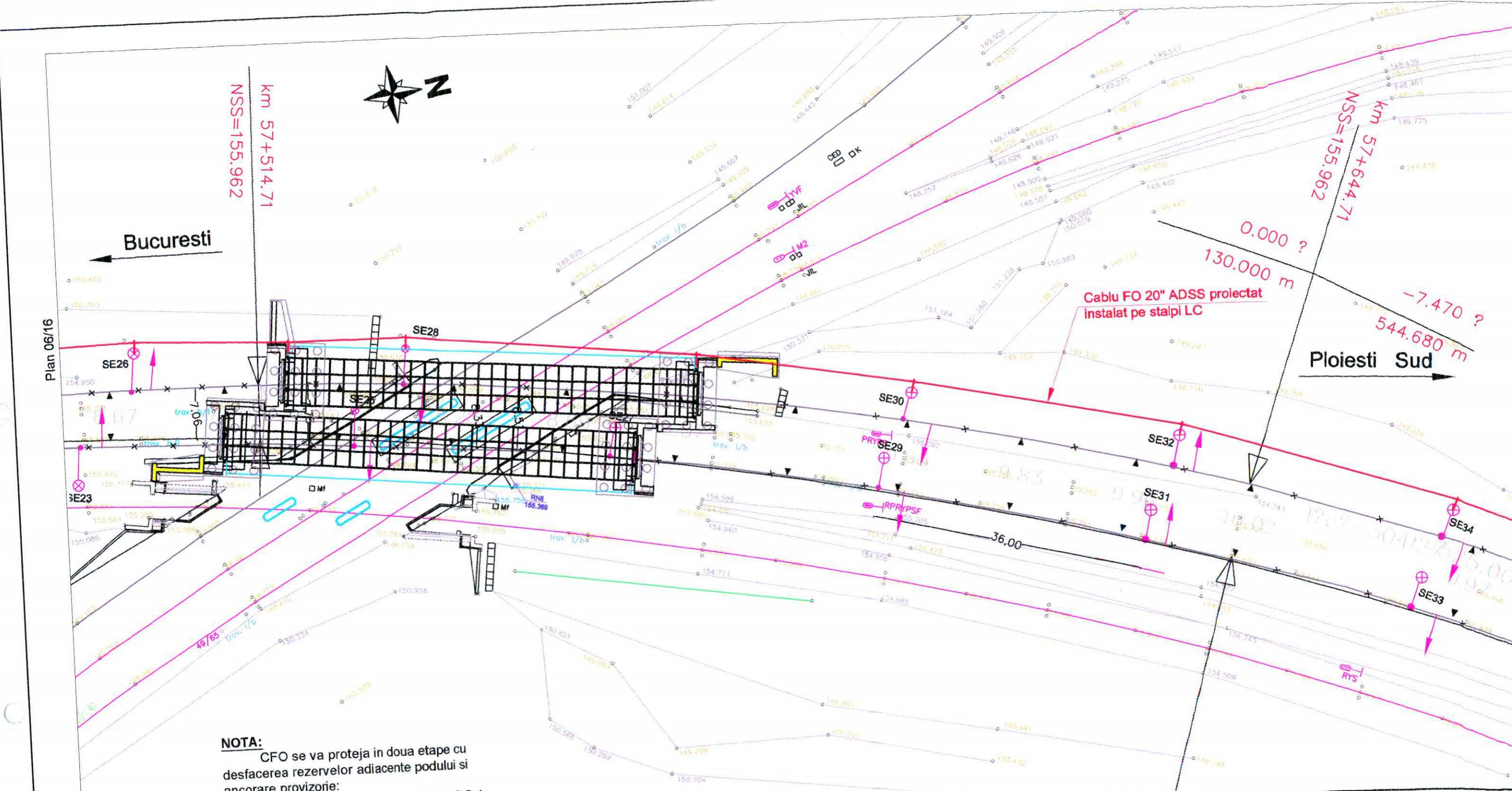

**NOTA:**  
 CFO se va proteja in doua etape cu  
 desfacerea rezervelor adiacente podului si  
 ancorare provizorie:  
 1 - relocare provizorie pe stalpi LC fir I;  
 2 - instalare definitiva pe stalpii LC noi fir II.

**ATENTIE!**  
 CABLURI  
 EXISTENTE IN FUNCTIUNE

---

RESPECTATI MASURILE PRIVIND  
 SANATATEA SI SECURITATEA IN MUNCA  
 SI SITUATIILE DE URGENTA

**LEGENDA**

— Cablu fibra optica 20" proiectat, relocat definitiv

—⊕— Ancora cablu FO la stalp nou

B			
A			
BENEFICIAR/ BENEFICIARY:		Modificare Modification / Revision AUTORITATEA DE IMPLEMENTARE/ IMPLEMENTUNG AUTHORITY	AUTORITATEA CONTRACTANTA / CONTRACTING AUTHORITY
ROMANIAN RAILWAY NATIONAL COMPANY		Ministerul Transporturilor Ministry of Transport	Ministerul Economiei si Finantelor Oficiu de Plati si Contractare Phare Ministry of Economy and Finance Phare Payments & Contracting Office
prointec		CONSYS PROJECT	POS Transport 2007- 2013
PORTOFOLIUL DE PROIECTE PHARE CES 2005 / PHARE CES 2005 PROJECTS PORTFOLIO LOT 1			
Intocmit / Designed	Ing. Raliade Lucian	<i>L. Raliade</i>	Scara / Scale : 1:500
Verificat / Checked	Ing. Enache Florin	<i>F. Enache</i>	Data / Date :
Sef echipa / Team leader	Ing. Stelian Vara-Oros	<i>S. Vara-Oros</i>	07.2010
Denumire desen / Drawing Title : Sucursala RCF/ Railway district Bucuresti Linia cf /Railway line 300 Bucuresti-Ploiesti Pod / Bridge km 57+580 Protectie cabluri de telecomunicatii la pod/Bridge TTR cables protection			Cod desen / Drawing Code PD 21



Plan 07/16

P2  
Km 57+700

Cablu FO 20" ADSS proiectat  
instalat pe stalpi LC

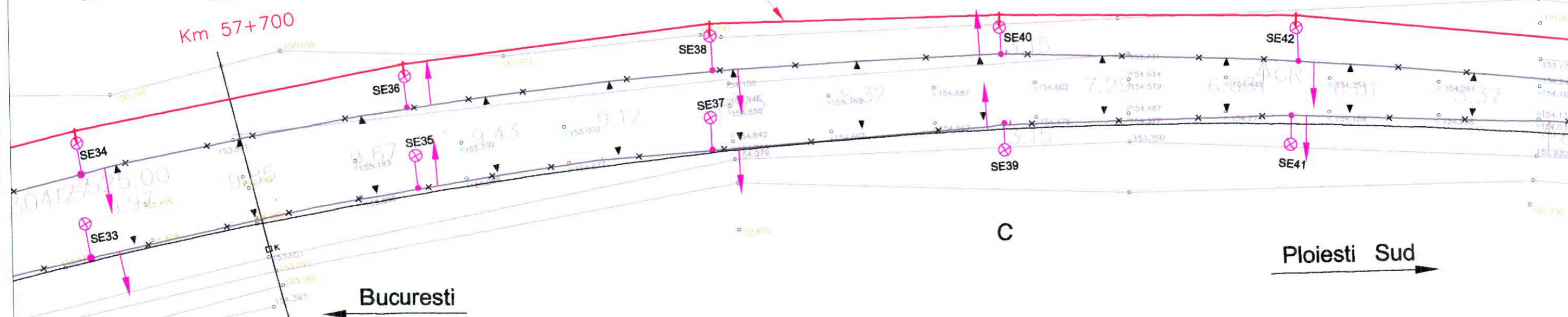

**NOTA:**  
CFO se va proteja in doua etape cu  
desfacerea rezervelor adiacente podului si  
ancorare provizorie:  
1 - relocare provizorie pe stalpi LC fir I;  
2 - instalare definitiva pe stalpii LC noi fir II.

**ATENTIE !**  
CABLURI  
EXISTENTE IN FUNCTIUNE

---

RESPECTATI MASURILE PRIVIND  
SANATATEA SI SECURITATEA IN MUNCA  
SI SITUATIILE DE URGENTA

**LEGENDA**

— Cablu fibra optica 20" proiectat, relocat definitiv

— ⊕ Ancora cablu FO la stalp nou

B			
A			
BENEFICIAR / BENEFICIARY:		Modificare Modification / Revision	
ROMANIAN RAILWAY NATIONAL COMPANY		AUTORITATEA DE IMPLEMENTARE / IMPLEMENTUNG AUTHORITY	AUTORITATEA CONTRACTANTA / CONTRACTING AUTHORITY
Ministerul Transporturilor Ministry of Transport		Ministerul Economiei si Finantelor Oficiu de Plati si Contractare Phare Ministry of Economy and Finances Phare Payments & Contracting Office	<b>CFCU</b> Con Cor 1301
			F P Pt
Intocmit Designed	Ing. Raliade Lucian	Scara / Scale: 1:500	PORTOFOLIUL DE PROIECTE PHARE CES 2005 / PHARE CES 2005 PROJECTS PORTFOLIO LOT 1
Verificat Checked	Ing. Enache Florin	Data / Date:	Asistenta tehnica pentru pregatirea unor lucrari de reabilitare pentru tuneluri si poduri de cale Technical assistance for preparing rehabilitation works required by railway tunnels and bridges
Sef echipa Team leader	Ing. Stelian Vara-Oros	07.2010	Denumire desen / Drawing Title: Sucursala RCF / Railway district Bucuresti Liniile de / Railway line 300 Bucuresti-Ploiesti Pod / Bridge km 57+560 Protectie cabluri de telecomunicatii la pod/Bridge TTR cables protection
			Cod desen / Drawing Code PD 21





Cablu FO 20" ADSS proiectat  
 instalat pe stalpi LC

Plan 08/16

Plan 10/10

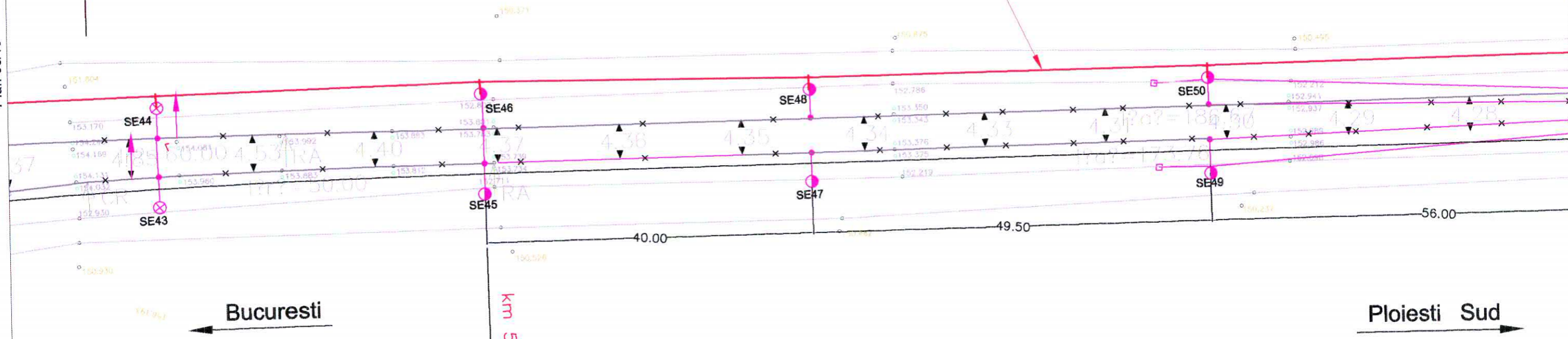

Bucuresti

Ploiesti Sud

**NOTA:**  
 CFO se va proteja in doua etape cu  
 desfacerea rezervelor adiacente podului si  
 ancorare provizorie:  
 1 - relocare provizorie pe stalpi LC fir I;  
 2 - instalare definitiva pe stalpii LC noi fir II.

**ATENTIE!**  
 CABLURI  
 EXISTENTE IN FUNCTIUNE

RESPECTATI MASURILE PRIVIND  
 SANATATEA SI SECURITATEA IN MUNCA  
 SI SITUATIILE DE URGENTA

**LEGENDA**

— Cablu fibra optica 20" proiectat, relocat definitiv

— ⊕ Ancora cablu FO la stalp nou

B				
A				
BENEFICIAR/ BENEFICIARY:		AUTORITATEA DE IMPLEMENTARE/ IMPLEMENTUNG AUTHORITY		AUTORITATEA CONTRACTANTA / CONTRACTING AUTHORITY
ROMANIAN RAILWAY NATIONAL COMPANY		Ministerul Transporturilor Ministry of Transport		Ministerul Economiei si Finantelor Oficiul de Plati si Contractare Phare Ministry of Economy and Finances Phare Payments & Contracting Office
Intocmit / Designed <b>Ing. Raliade Lucian</b>		Verificat / Checked <b>Ing. Enache Florin</b>		Sef echipa / Team leader <b>Ing. Stelian Vara-Oros</b>
Scara / Scale:		1:500		
Data / Date:		07.2010		
PORTOFOLIUL DE PROIECTE PHARE CES 2005 / PHARE CES 2005 PROJECTS PORTFOL LOT 1 Asistenta tehnica pentru pregatirea unor lucrari de reabilitare pentru tuneluri si poduri de cale ferata Technical assistance for preparing rehabilitation works required by railway tunnels and bridge				
Denumire desen / Drawing Title:			Cod desen / Drawing Code	Nr. /
Sucursala RCF/ Railway district Bucuresti Linie cf / Railway line 300 Bucuresti-Ploiesti Pod / Bridge km 57+560			PD 21	01 / 11
Protectie cabluri de telecomunicatii la pod/Bridge TTR cables protection				

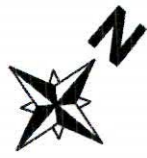

Cablu FO 20" ADSS proiectat  
instalat pe stalpi LC

-7.470 ?  
544.680 m

Mufa cablu FO  
si rezerve pe suport

Plan 09/16

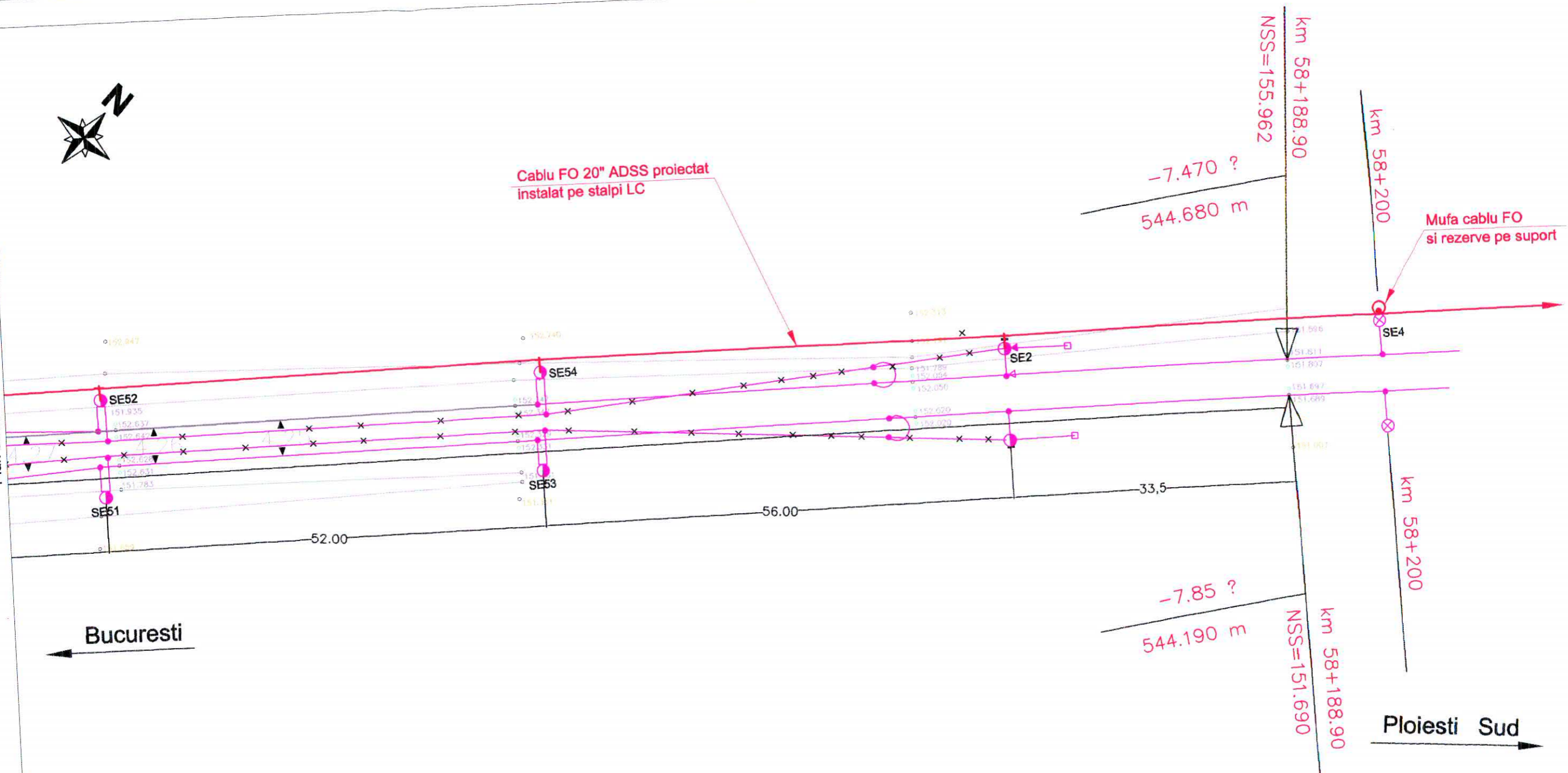

Bucuresti

-7.85 ?  
544.190 m

Ploiesti Sud



**NOTA:**  
CFO se va proteja in doua etape cu  
desfacerea rezervelor adiacente podului si  
ancorare provizorie:  
1 - relocare provizorie pe stalpi LC fir I;  
2 - instalare definitiva pe stalpii LC noi fir II.

**ATENTIE !**

CABLURI  
EXISTENTE IN FUNCTIUNE

RESPECTATI MASURILE PRIVIND  
SANATATEA SI SECURITATEA IN MUNCA  
SI SITUATIILE DE URGENTA

**LEGENDA**

 Cablu fibra optica 20" proiectat, relocat definitiv  
 Ancora cablu FO la stalp nou

B			
A			
BENEFICIAR/ BENEFICIARY:		Modificare Modification / Revision	AUTORITATEA CONTRACTANTA / CONTRACTING AUTHORITY
ROMANIAN RAILWAY NATIONAL COMPANY		Ministerul Transporturilor Ministry of Transports	Ministerul Economiei si Finantelor Oficiul de Plati si Contractare Phare Ministry of Economy and Finances Phare Payments & Contracting Office
		prointec	CONSIS PROIECT
Intocmit Designed		Ing. Raliade Lucian	Scara / Scale : 1:500
Verificat Checked		Ing. Enache Florin	Data / Date :
Sef echipa Team leader		Ing. Stelian Vara-Oros	07.2010
		PORTOFOLIUL DE PROIECTE PHARE CES 2005 / PHARE CES 2005 PROJECTS PORTFOLIO LOT 1	
		Asistenta tehnica pentru pregatirea unor lucrari de reabilitare pentru tuneluri si poduri de cale ferata Technical assistance for preparing rehabilitation works required by railway tunnels and bridges	
		Denumire desen / Drawing Title : Sucursala RCF/ Railway district Bucuresti Linia cf/ Railway line 300 Bucuresti-Ploiesti Pod / Bridge km 57+560	
		Protectie cabluri de telecomunicatii la pod/Bridge TTR cables protection	
		Cod desen / Drawing Code : PD 21	